

Single valve-gate nozzle

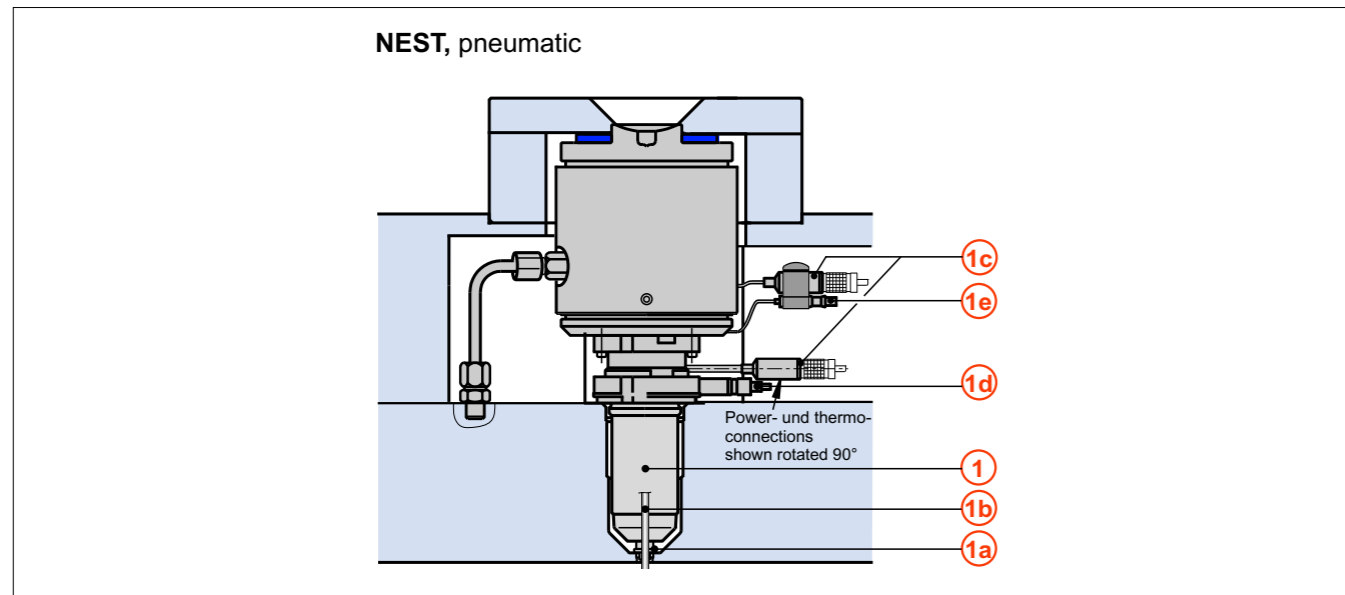

Signs and symbols:

- ① Valve-gate nozzle, chapter 2.3
- ①a PM needle guide, chapter 7
- ①b Valve needle, chapter 7
- ①c Power receptacle, chapter 6
- ①d Thermoplug, chapter 6
- ①e Fixed thermocouple connection

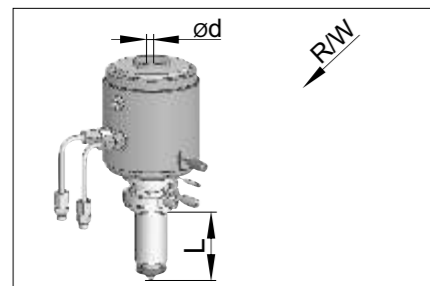

NEST, pneumatic

① NEST Single nozzle, pneumatic with valve-gate

Order code	Nozzle-ød (mm)	Nozzle length L (mm)
5__	4,8	40 ... 100
6__	6,0	40 ... 150
8__	7,5	60 ... 200
10__	10	60 ... 250
12__	12	60 ... 250

Please indicate the nozzle length, nozzle head design and actuation medium in your order.
Example: 5NEST80/...../R40

Design of nozzle head

Order code	Radius/ Angle
__/G__	Straight
__/R__	R 7 - 40
__/W__	W 90° - 136°

Actuation medium

Order code	Actuation medium	Type
__/L__	Pneumatic	NEST

①a PM Needle guide

Design	Gate ø mm									
	0.8	1.0	1.2	1.4	1.6	2.0	2.5	3.0	3.5	4.0
LA	•	•	•	•	•	•	•	•	•	•
LAZ	•	•	•	•	•	•	•			

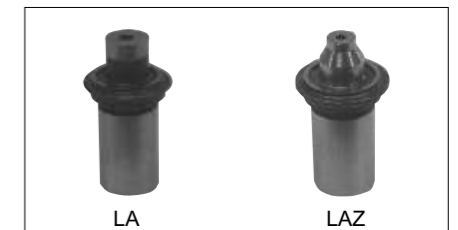

①b NEP Valve needle NEP

Needle ø mm	Gate ø mm								Material-tube-ø mm nozzle	
	0.8	1.0	1.2	1.4	1.6	2.0	2.5	3.0		4.0
2	•	•	•	•	•					4 - 6
3						•	•			8
5								•	•	10, 12

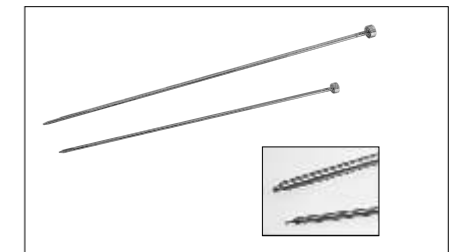

①c CMT Power receptacle 2x necessary

Order code	Cable length (m)
CMT50	0.5
CMT100	1.0
CMT150	1.5
CMT200	2.0
CMT250	2.5

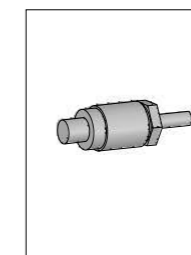

①d CMLK Thermoplug 1x necessary

Order code	Cable length (m)
CMLK50	0,5
CMLK100	1,0
CMLK150	1,5
CMLK200	2,0
CMLK250	2,5

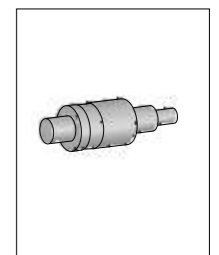

①e Fixed thermo connection 1x necessary

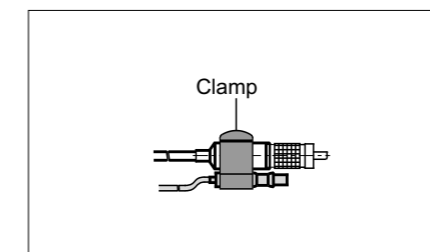

HK-S I
 NEST
 HK-S II
 NFT
 NHT
 NLT
 NMT
 NNT
 NTT